



INSTRUCTION BULLETIN

No. 340221
Machine: 6200
Published: 9-99/00
System: OPTIONS

NOTE: DO NOT DISCARD the Parts List from the Instruction Bulletin. Place the Parts List in the appropriate place in your machine manual for future reference. Retaining the Parts List will make it easier to reorder individual parts and will save you the cost of ordering an entire kit.

NOTE: Numbers in parenthesis () are reference numbers for parts listed in Bill of Materials.

Installation instructions for kit number 383971

SYNOPSIS / PROBLEM:

This kit contains the parts needed to install a seat slide rail kit on the model 6200 sweeper. Please follow step-by-step instructions.

SPECIAL TOOLS / CONSIDERATIONS: NONE

(Estimated time to complete: 1 hour)

PREPARATION:

(Refer to FIG. 1)

FOR SAFETY: Before leaving or servicing machine, stop on level surface and set parking brake. Then turn off machine and remove key.

INSTALLATION:

(Refer to FIG. 1)

1. Lift the seat weldment and lock in place with the support rod.
2. Remove seat mounting hardware and remove seat from the seat weldment.
3. Mount the right rail (1) under the right side of the seat with two pan screws (4) and four washers (3). (Refer to FIG. 1)
4. Mount the left rail (2) under the left side of the seat with two pan screws (4) and four washers (3). Check that the left slide rail (2) is mounted with the engaging/disengaging lever on the outside and pointing towards the front of the machine. (Refer to FIG. 1)
5. Mount the seat with new installed slide rails (1 and 2) back on the seat weldment with four washers (6) and hex nuts (5). (Refer to FIG. 1)
6. Disengage the seat prop rod, and close the seat weldment
7. Check the seat slide rails for proper operation.

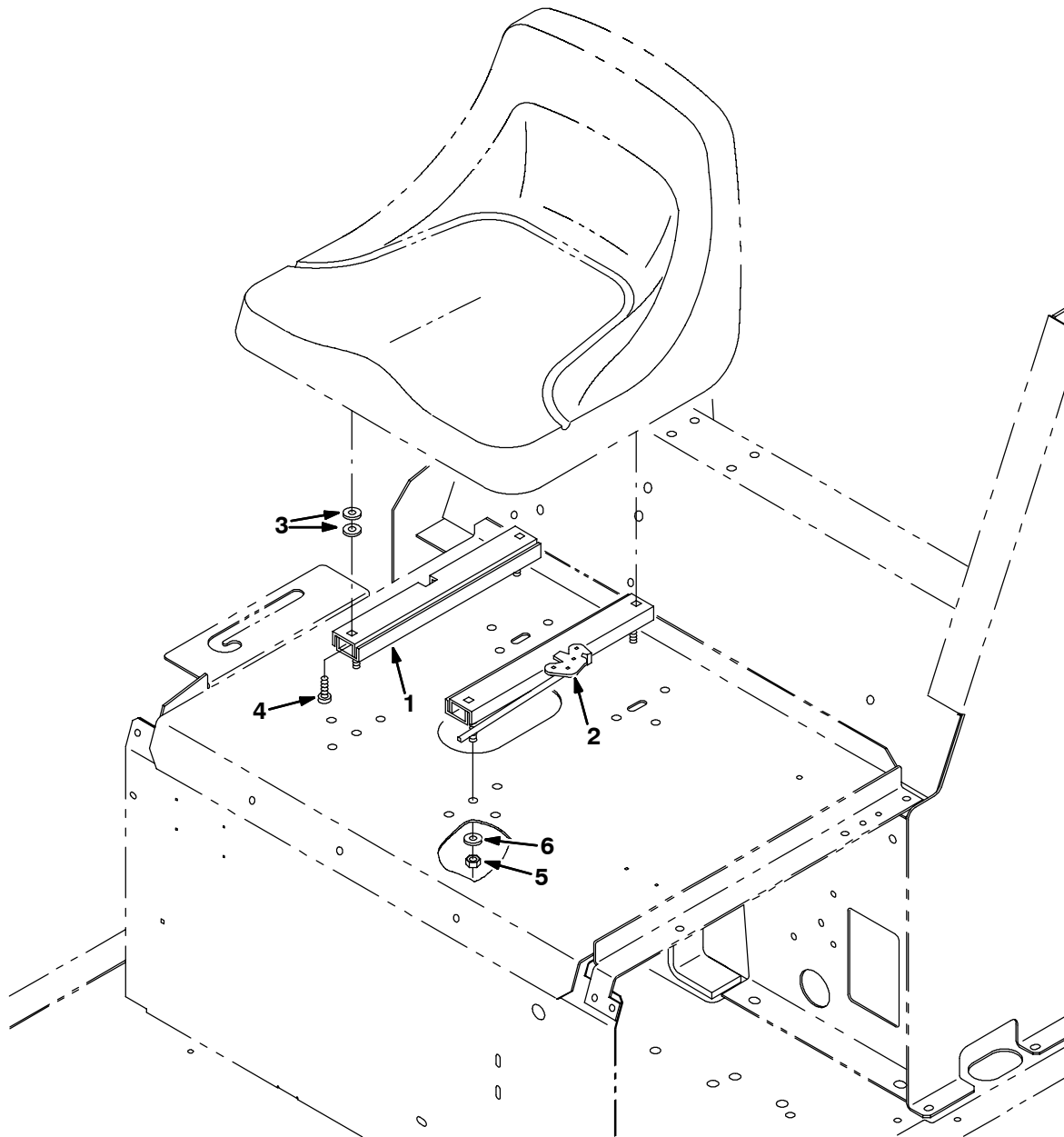

FIG. 1 - SLIDE RAIL KIT INSTALLATION

BILL OF MATERIALS FOR SEAT SLIDE RAIL KIT 383971

Ref.	TENNANT Part No.	Description	Qty.
1	360369	Rail	1
2	360370	Rail	1
3	69461	Washer	8
4	25537	Screw, Pan, .31-18 X 0.75, G1	4
5	32983	Nut, Hex, Lock, .31-18	4
6	32491	Washer, Flat, .31 Hard	4

TENNANT COMPANY
P. O. Box 1452
Minneapolis, MN 55440-1452